

**Expand
Enhance
Ensure**



God's Treehouse

Siesta Key Chapel Facility Plans Space and Facility Requirements



In March 2005 the Session formed a Committee to evaluate long-term facility requirements.

Committee members:

- Taylor Bodkin**
- Fred Heina**
- Walt Olson**
- Cal Owen**
- Dick Ulrich**
- Liz Smith**
- Elton White, Chairperson**

The Committee surveyed the Session and staff in order to analyze current use of existing spaces.

Four town hall meetings have been held to review plans and receive feedback from the congregation in addition to several meetings with individuals.



The plans have been modified significantly based on this feedback.

IN ADDITION...

- **Smith Architects and Delta Southern, General Contractor, have been hired as partners.**
- **Architectural, engineering, sound-proofing work and preliminary cost estimates have been done to validate the plans.**

*The Session approved the plans
on January 30, 2007 and called*

**Our goal is to satisfy
our safety and space requirements
in the most cost-effective manner
while incurring the least possible
inconvenience.**

An Overview of Current Facility Needs



**A NEED FOR BETTER
SAFETY & PROTECTION**

- 1. Truss repairs and support**
- 2. Hurricane shutters**
- 3. New fire protection system**
- 4. Need lift**
- 5. Fire Marshall requires interlocking and non-folding chairs**
- 6. Electrical upgrades in renovated areas**

A NEED FOR OPERATIONAL IMPROVEMENTS

- 1. Christian education space today is inadequate**
- 2. Additional restrooms are needed on the sanctuary level**
- 3. Offices need to be moved above the flood level**
- 4. We need additional and more efficient office space and work areas**
- 5. More storage**

- 6. Permanent walls for stage in Fellowship Hall**
- 7. Elevate pulpit to make Pastor and worship leaders more visible**
- 8. Need additional seating in the Sanctuary**
- 9. Larger deck at Sanctuary entrance**
- 10. Covered play area for children**

The Plan ?

Expand
Enhance
Ensure



Ground Level Plan

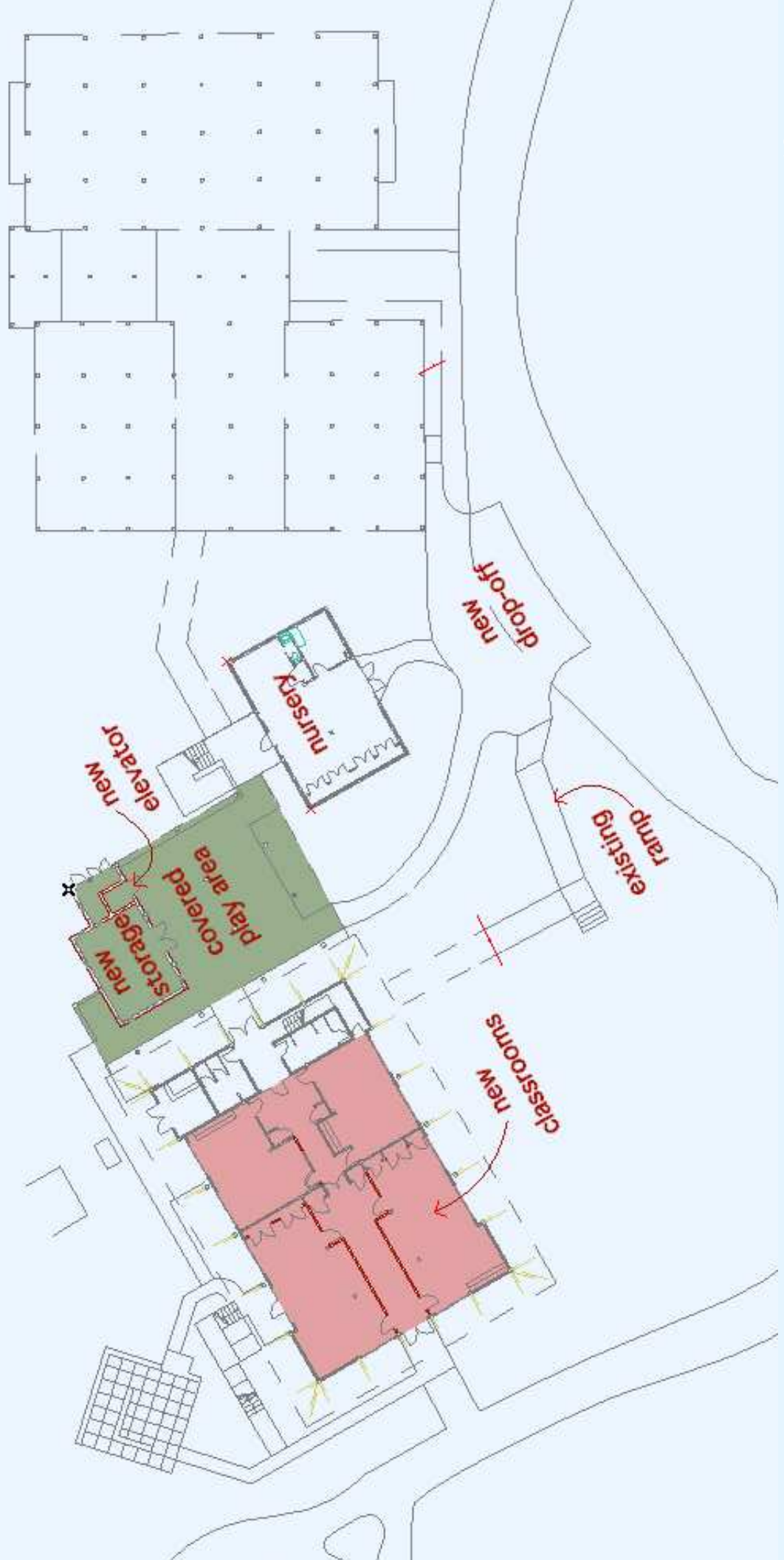

Main Level Plan

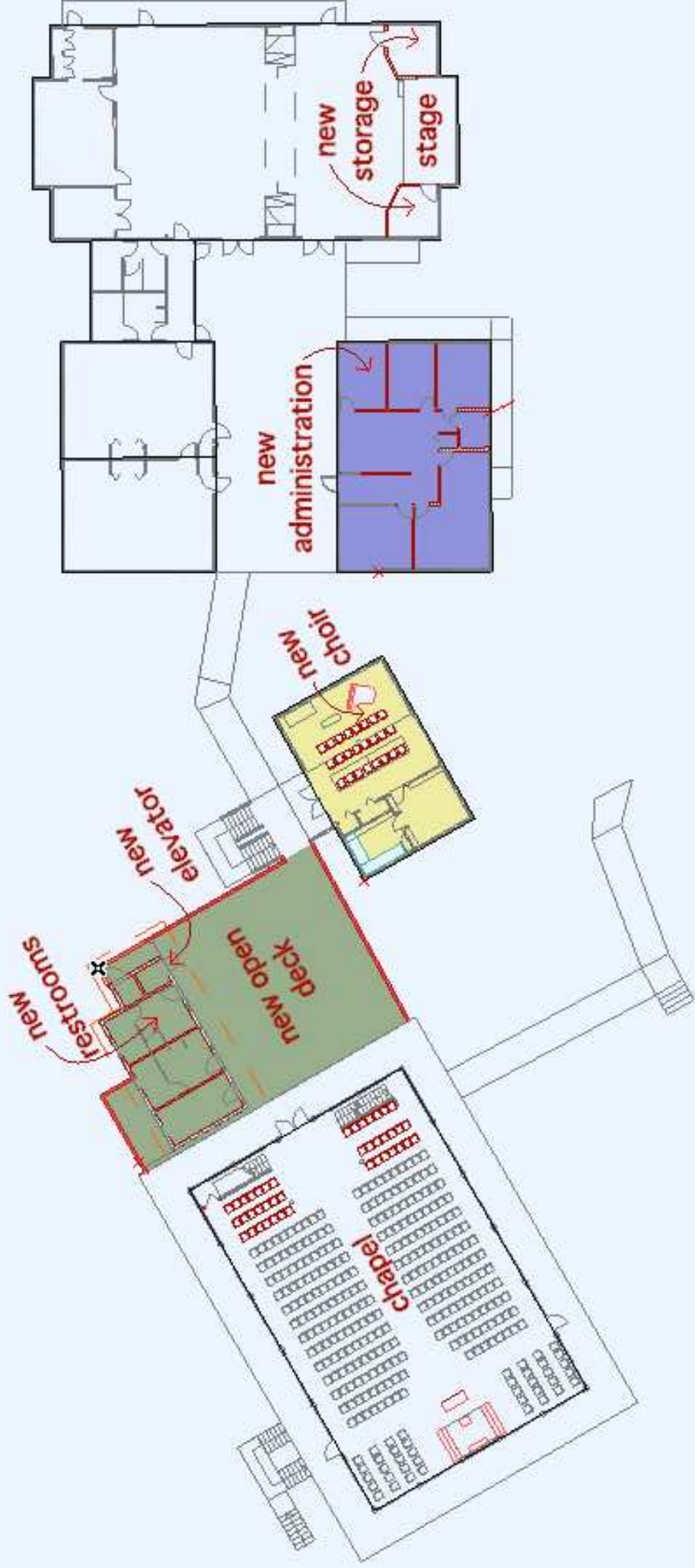



Benefits of Proposed Master Plan

- 1. Life of Chapel will be extended and safer for use with the truss work, hurricane shutters and fire protection system.**
- 2. Insurance availability and rates will benefit from shutters and fire protection system**
- 3. The elevator, paved drop off area, and restrooms on the same level as sanctuary will benefit a number of our members and guests**

continued...

- 4. All offices will be above the flood level**
- 5. It will eliminate current schedule conflicts for Fellowship Hall**
- 6. Permanent walls for the stage in Fellowship Hall will improve its effectiveness and safety**
- 7. The outdoor deck will greatly enhance socializing with the congregation and eliminate bottlenecks on the balcony after services**
- 8. The Pastor and worship leaders will be more visible**

By The Numbers...

- **Increased seating in the Sanctuary, approximately 42 seats will be added**
- **2 (possibly 3) classrooms will be added**
- **Office space will be increased from 4 to 6**
- **Additional restrooms, 1 for men and 1 for women**

Next Steps

- 1. Review the needs and construction plans with the congregation**
- 2. Carry out the “Expand, Enhance, Ensure” Capital Campaign, Feb.14 to March 18.**
- 3. Dedicate campaign pledges March 18 during worship**

4. Finalize cost estimates and the timing of the work in March

5. Anticipated construction:

April - August 2007



Expected inconveniences during construction

- **Worship will need to be held in Fellowship Hall during some of the summer months**
- **At times it will be necessary to reroute access to particular classrooms or buildings**

*Rest assured, the congregation
will be fully informed
of any required changes*

Your prayers, patience
and assistance are requested
as we strive to

Expand
Enhance
Ensure...

God's Treehouse